

UT1000系列

压力传感器 pressure sensor

- 量程/Range 0...600Bar
- 高性能芯体/High performance core
- 多种安装接口可选/Multiple Process connection optional
- 高精度/High accuracy
- 多种电气连接方式/Multiple electrical connections
- 长期稳定性好/Superior long term stability
- 抗干扰能力强/Strong antiinterference ability



技术规格

产品性能/Product Performance	
长期漂移/Long-Term Stability	0.1%FS/year (不累计/Not cumulative)
精度/Accuracy	±0.5%FS, ±0.25%FS (可选)
温度影响/Temp.Effect	1.5FS/100°C
补偿温度/Comp.Temp.	-20°C~80°C
工作温度/Working Temp.	-40°C~125°C
零点允差/Zero Error	1%FS
满程允差/Span Error	1%FS
响应时间/Response Time	<2ms
疲劳寿命/Fatigue Life	设计超过1亿次/More than 100 million designs
物理特征/Physical Characteristics	
安装接口/Pressure Interface	参见订购指南/See Ordering Guide
接液部件/Contact Parts	不锈钢/Stainless steel
电气接口/Electrical Interface	参见订购指南/See Ordering Guide
外壳防护/Shell Protection	IP65/IP67
抗冲击/Shock	EC 68-2-32 procedure I
抗振动/Vibration	40g, 20-2000Hz
重量/Weight	约100克/About 100g
质保/ Guarantee period	2年

特有技术规格/Specific technical specifications
电压输出/Voltage Output

输出 (3线) /Output (3-wire)	最小0V至最大10V/Min 0V to max 10V
供电电压/Power Supply	高于满量程输出4V, 最大30Vdc Over full range output 4V, max 30Vdc

电流输出/Current Output

输出 (2线) /Output (2-wire)	4-20mA (2线) /2-wire
供电电压/Power Supply	10-30Vdc

压力特性/Pressure feature

压力范围/Range Kpa / bar	耐压/Proof Pressure (×FS)	破裂压/Burst Pressure (×FS)
	SSM-P210	SSM-P210
真空/Vacuum	5.0×FS	10.0×FS
5~100kpa	2.0×FS	5.0×FS
200kpa~100bar	2.0×FS	3.0×FS
200bar~700bar	1.5×FS	2.0×FS

接线方式/Pinconnections

类型 Type	端子 Terminal	电流 2-wire Current signal	电压 3-wire Voltage signal
M12*1	1	+ve供电/Supply	+ve供电/Supply
	2	+ve输出/Output	0V公用端/Com
	3		+ve输出/Output
	4		
DIN	1	+ve供电/Supply	+ve供电/Supply
	2	+ve输出/Output	0V公用端/Com
	3		+ve输出/Output
	GND		

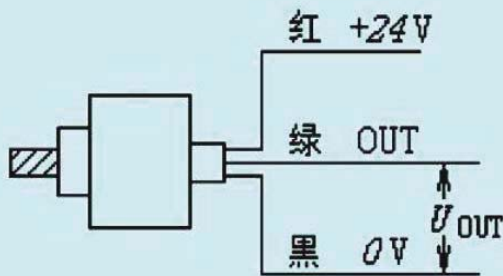
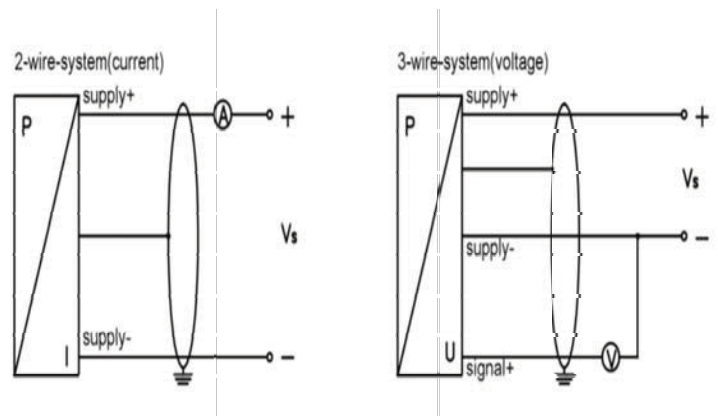

(a) 电压输出型

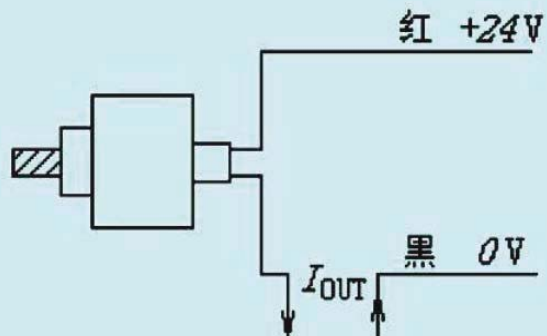

(b) 电流输出型

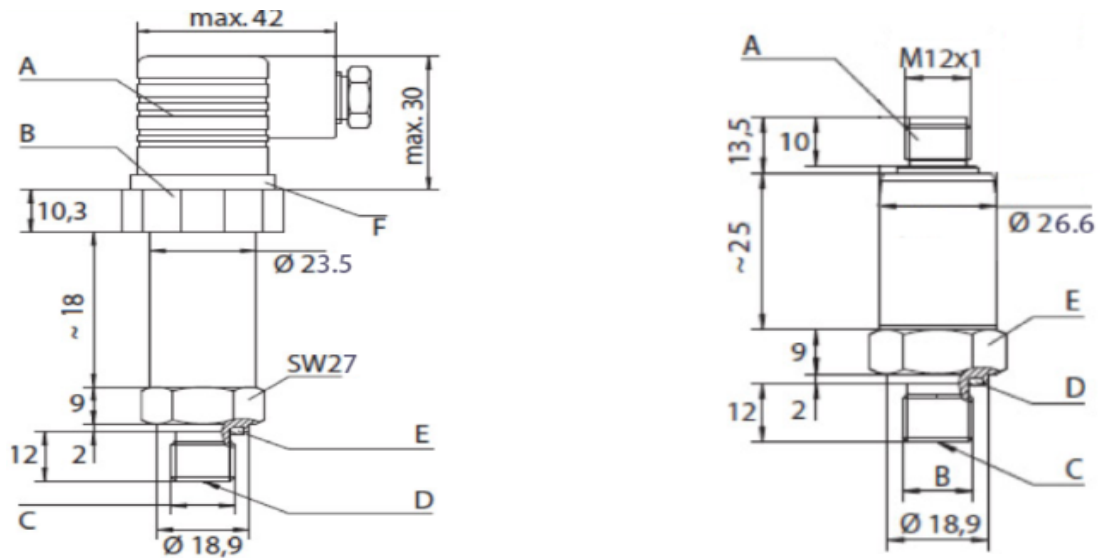
外形尺寸/Dimensions

压力传感器选型-赫斯曼插头 (DIN EN 175301-803A型)

量程		订货号	
bar	MPa	4...20mA	0...10V
-1...6	-0.1...0.6	UT1000-006-01C1.0	UT1000-006-01V1.0
0...10	1...1.0	UT1000-010-01C1.0	UT1000-010-01V1.0
0...25	0...2.5	UT1000-025-01C1.0	UT1000-025-01V1.0
0...60	0...6.0	UT1000-060-01C1.0	UT1000-060-01V1.0
0...100	0...10	UT1000-100-01C1.0	UT1000-100-01V1.0
0...250	0...25	UT1000-250-01C1.0	UT1000-250-01V1.0
0...400	0...40	UT1000-400-01C1.0	UT1000-400-01V1.0
0...600	0...60	UT1000-600-01C1.0	UT1000-600-01V1.0

压力传感器选型-航空插头 (4针, M12X1)

量程		订货号	
bar	MPa	4...20mA	0...10V
-1...6	-0.1...0.6	UT1000-006-02C1.0	UT1000-006-02V1.0
0...10	1...1.0	UT1000-010-02C1.0	UT1000-010-02V1.0
0...25	0...2.5	UT1000-025-02C1.0	UT1000-025-02V1.0
0...60	0...6.0	UT1000-060-02C1.0	UT1000-060-02V1.0
0...100	0...10	UT1000-100-02C1.0	UT1000-100-02V1.0
0...250	0...25	UT1000-250-02C1.0	UT1000-250-02V1.0
0...400	0...40	UT1000-400-02C1.0	UT1000-400-02V1.0
0...600	0...60	UT1000-600-02C1.0	UT1000-600-02V1.0

备注：默认安装螺纹是G1/4外螺纹，特殊规格及量程请咨询我司相关销售人员。